



Mount Row

, Mayfair, W1K 3SG

£1,600 Per Week

An extremely well presented, spacious and superbly located two large bedrooms apartment, on the second floor (secured lift entrance) of an exclusive residential building, situated on a quiet side road off Mount Street and within moments walk of Berkeley Square, Bond Street, Piccadilly and the entertaining West End. Green Park and St James Park are within walking distance.

This fine property comprises of: large reception /dining room, sliding doors to fitted kitchen, double doors leading out onto a brilliant balcony, Affording two excellent double bedrooms with en-suites bathroom/walkin shower and WC, e/s shower/WC (both with ample wardrobes) , guest WC.

The apartment also benefits from:- Secure entry phone, direct lift access (CODED LIFT ENTRY), wooden flooring and gas central heating. The property is to let furnished, available NOW for LONG LET ONLY.

- Two Double bedrooms
- Two bathrooms/WC (2 e/s)
- Guest WC
- Bright and Modern
- Reception/dining room
- Wood flooring
- Air conditioning
- Private lift & large balcony

Viewing

Please contact our Messila Residential Office on 020 7586 6699 if you wish to arrange a viewing appointment for this property or require further information.



Floor Plan

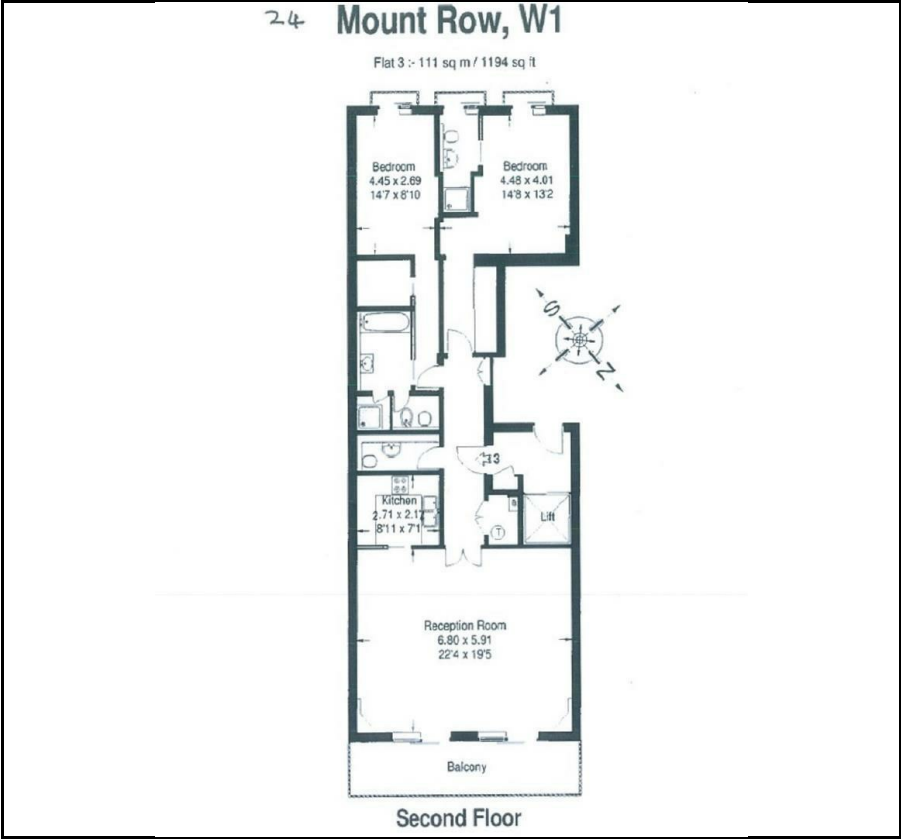

Area Map



Energy Efficiency Graph

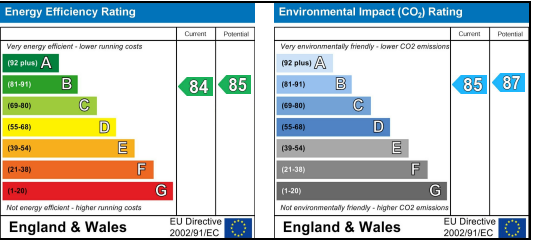

These particulars, whilst believed to be accurate are set out as a general outline only for guidance and do not constitute any part of an offer or contract. Intending purchasers should not rely on them as statements of representation of fact, but must satisfy themselves by inspection or otherwise as to their accuracy. No person in this firms employment has the authority to make or give any representation or warranty in respect of the property.